

PremFast

PREMIER FASTENER SUPPLIES

Square Weld Nuts Din 928 Metric Sizes

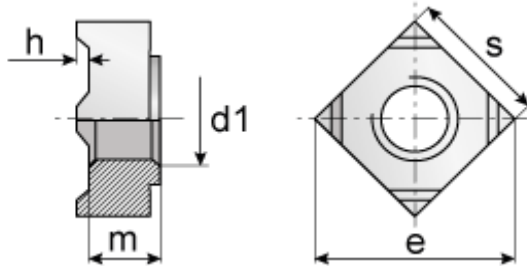

d1	M4	M5	M6	M8	M10	M12
e	9	12	13	18	22	25
h +0,1	0.6	0.8	0.8	1	1.2	1.4
m	3.5	4.2	5	6.5	8	9.5
s	7	9	10	14	17	19

Hex Weld Nuts Din 929 Metric Sizes

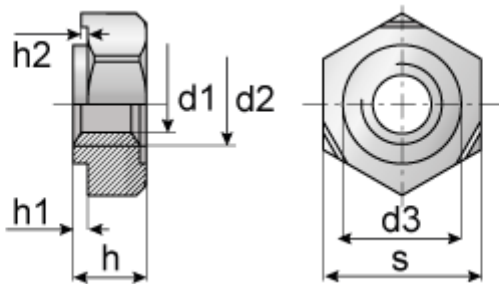

d1	M3	M4	M5	M6	M8	M10	M12	M14	M16
d2	4.5	6	7	8	10.5	12.5	14.8	16.8	18.8
d3	4.5	6	7	8	10.5	12.5	14.8	16.8	18.8
drill	4.5	6	7	8	10.5	12.5	14.8	16.8	18.8
h1	0.55	0.65	0.7	0.75	0.9	1.15	1.4	1.8	1.8
h2	0.25	0.35	0.4	0.4	0.5	0.65	0.8	1	1
h	3	3.5	4	5	6.5	8	10	11	13
s	7.5	9	10	11	14	17	19	22	24